

# ELEVATION CERTIFICATE

**Important:** Follow the instructions on pages 1-9.

Copy all pages of this Elevation Certificate and all attachments for (1) community official, (2) insurance agent/company, and (3) building owner.

SECTION A - PROPERTY INFORMATION	FOR INSURANCE COMPANY USE
A1. Building Owner's Name Jeanette Morales	Policy Number:
A2. Building Street Address (including Apt., Unit, Suite, and/or Bldg. No.) or P.O. Route and Box No. 207 Atlanta Avenue	Company NAIC Number:
City Carolina Beach	State North Carolina
	ZIP Code 28428
A3. Property Description (Lot and Block Numbers, Tax Parcel Number, Legal Description, etc.) Lot 7, Carolina Beach, Map Book 235, page 601	
A4. Building Use (e.g., Residential, Non-Residential, Addition, Accessory, etc.) <u>Residential</u>	
A5. Latitude/Longitude: Lat. <u>34-01-49.6</u> Long. <u>77-53-46.4</u> Horizontal Datum: <input type="checkbox"/> NAD 1927 <input checked="" type="checkbox"/> NAD 1983	
A6. Attach at least 2 photographs of the building if the Certificate is being used to obtain flood insurance.	
A7. Building Diagram Number <u>5</u>	
A8. For a building with a crawlspace or enclosure(s):	
a) Square footage of crawlspace or enclosure(s) <u>0</u> sq ft	
b) Number of permanent flood openings in the crawlspace or enclosure(s) within 1.0 foot above adjacent grade <u>0</u>	
c) Total net area of flood openings in A8.b <u>0</u> sq in	
d) Engineered flood openings? <input type="checkbox"/> Yes <input type="checkbox"/> No	
A9. For a building with an attached garage:	
a) Square footage of attached garage <u>0</u> sq ft	
b) Number of permanent flood openings in the attached garage within 1.0 foot above adjacent grade <u>0</u>	
c) Total net area of flood openings in A9.b <u>0</u> sq in	
d) Engineered flood openings? <input type="checkbox"/> Yes <input type="checkbox"/> No	

SECTION B - FLOOD INSURANCE RATE MAP (FIRM) INFORMATION					
B1. NFIP Community Name & Community Number Town of Carolina Beach 375347			B2. County Name New Hanover		B3. State North Carolina
B4. Map/Panel Number 3720313000	B5. Suffix J	B6. FIRM Index Date 02/16/2007	B7. FIRM Panel Effective/ Revised Date 04/03/2006	B8. Flood Zone(s) AE	B9. Base Flood Elevation(s) (Zone AO, use Base Flood Depth) 13.0

B10. Indicate the source of the Base Flood Elevation (BFE) data or base flood depth entered in Item B9:  
 FIS Profile  FIRM  Community Determined  Other/Source: \_\_\_\_\_

B11. Indicate elevation datum used for BFE in Item B9:  NGVD 1929  NAVD 1988  Other/Source: \_\_\_\_\_

B12. Is the building located in a Coastal Barrier Resources System (CBRS) area or Otherwise Protected Area (OPA)?  Yes  No  
 Designation Date: \_\_\_\_\_  CBRS  OPA

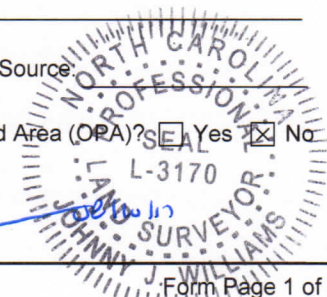

# ELEVATION CERTIFICATE

OMB No. 1660-0008  
Expiration Date: November 30, 2018

<b>IMPORTANT: In these spaces, copy the corresponding information from Section A.</b>			<b>FOR INSURANCE COMPANY USE</b>
Building Street Address (including Apt., Unit, Suite, and/or Bldg. No.) or P.O. Route and Box No. 207 Atlanta Avenue			Policy Number:
City Carolina Beach	State North Carolina	ZIP Code 28428	Company NAIC Number

## SECTION C – BUILDING ELEVATION INFORMATION (SURVEY REQUIRED)

C1. Building elevations are based on:  Construction Drawings\*  Building Under Construction\*  Finished Construction  
\*A new Elevation Certificate will be required when construction of the building is complete.

C2. Elevations – Zones A1–A30, AE, AH, A (with BFE), VE, V1–V30, V (with BFE), AR, AR/A, AR/AE, AR/A1–A30, AR/AH, AR/AO. Complete Items C2.a–h below according to the building diagram specified in Item A7. In Puerto Rico only, enter meters.

Benchmark Utilized: NCGS RTK network Vertical Datum: NAVD 1988

Indicate elevation datum used for the elevations in items a) through h) below.

NGVD 1929  NAVD 1988  Other/Source: \_\_\_\_\_

Datum used for building elevations must be the same as that used for the BFE.

Check the measurement used.

- |   |             |  |
|---|-------------|--|
| a) Top of bottom floor (including basement, crawlspace, or enclosure floor)   | <u>18.7</u> | <input checked="" type="checkbox"/> feet <input type="checkbox"/> meters |
| b) Top of the next higher floor   | <u>n/a.</u> | <input checked="" type="checkbox"/> feet <input type="checkbox"/> meters |
| c) Bottom of the lowest horizontal structural member (V Zones only)   | <u>n/a.</u> | <input checked="" type="checkbox"/> feet <input type="checkbox"/> meters |
| d) Attached garage (top of slab)  | <u>n/a.</u> | <input checked="" type="checkbox"/> feet <input type="checkbox"/> meters |
| e) Lowest elevation of machinery or equipment servicing the building<br>(Describe type of equipment and location in Comments) | <u>15.5</u> | <input checked="" type="checkbox"/> feet <input type="checkbox"/> meters |
| f) Lowest adjacent (finished) grade next to building (LAG)  | <u>3.6</u>  | <input checked="" type="checkbox"/> feet <input type="checkbox"/> meters |
| g) Highest adjacent (finished) grade next to building (HAG)   | <u>3.8</u>  | <input checked="" type="checkbox"/> feet <input type="checkbox"/> meters |
| h) Lowest adjacent grade at lowest elevation of deck or stairs, including structural support                                  | <u>3.6</u>  | <input checked="" type="checkbox"/> feet <input type="checkbox"/> meters |

## SECTION D – SURVEYOR, ENGINEER, OR ARCHITECT CERTIFICATION

This certification is to be signed and sealed by a land surveyor, engineer, or architect authorized by law to certify elevation information. I certify that the information on this Certificate represents my best efforts to interpret the data available. I understand that any false statement may be punishable by fine or imprisonment under 18 U.S. Code, Section 1001.

Were latitude and longitude in Section A provided by a licensed land surveyor?  Yes  No  Check here if attachments.

Certifier's Name Johnny J. Williams	License Number L-3170
--	--------------------------

Title Professional Land Surveyor
-------------------------------------

Company Name Johnny J. Williams Land Surveying, P.C.
---

Address P.O. Box 778
-------------------------

City Beulaville	State North Carolina	ZIP Code 28518
--------------------	-------------------------	-------------------

Signature 	Date 08/09/2017	Telephone (910) 298-8272
--	--------------------	-----------------------------

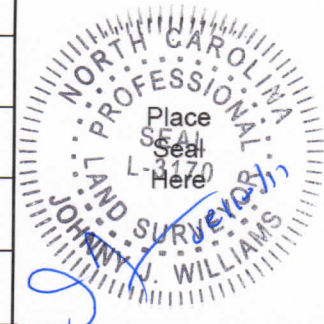

Copy all pages of this Elevation Certificate and all attachments for (1) community official, (2) insurance agent/company, and (3) building owner.

Comments (including type of equipment and location, per C2(e), if applicable)

C2e - The lowest equipment listed is the HVAC platform. Outlet under house is at elevation of 8.6'. Ceiling under finish floor listed in C2a is at an elevation of 14.4'

# BUILDING PHOTOGRAPHS

See Instructions for Item A6.

OMB No. 1660-0008  
Expiration Date: November 30, 2018

## ELEVATION CERTIFICATE

<b>IMPORTANT: In these spaces, copy the corresponding information from Section A.</b>			<b>FOR INSURANCE COMPANY USE</b>
Building Street Address (including Apt., Unit, Suite, and/or Bldg. No.) or P.O. Route and Box No. 207 Atlanta Avenue			Policy Number:
City Carolina Beach	State North Carolina	ZIP Code 28428	Company NAIC Number

If using the Elevation Certificate to obtain NFIP flood insurance, affix at least 2 building photographs below according to the instructions for Item A6. Identify all photographs with date taken; "Front View" and "Rear View"; and, if required, "Right Side View" and "Left Side View." When applicable, photographs must show the foundation with representative examples of the flood openings or vents, as indicated in Section A8. If submitting more photographs than will fit on this page, use the Continuation Page.



Photo One

Photo One Caption FRONT/SIDE VIEW



Photo Two

Photo Two Caption FRONT/SIDE VIEW

TENNY J. WILLIAMS  
 PROFESSIONAL SURVEYOR  
 STATE OF NORTH CAROLINA  
 License No. 3170

**ELEVATION CERTIFICATE**

**BUILDING PHOTOGRAPHS**

Continuation Page

OMB No. 1660-0008  
Expiration Date: November 30, 2018

<b>IMPORTANT: In these spaces, copy the corresponding information from Section A.</b>			<b>FOR INSURANCE COMPANY USE</b>
Building Street Address (including Apt., Unit, Suite, and/or Bldg. No.) or P.O. Route and Box No. 207 Atlanta Avenue			Policy Number:
City Carolina Beach	State North Carolina	ZIP Code 28428	Company NAIC Number

If submitting more photographs than will fit on the preceding page, affix the additional photographs below. Identify all photographs with: date taken; "Front View" and "Rear View"; and, if required, "Right Side View" and "Left Side View." When applicable, photographs must show the foundation with representative examples of the flood openings or vents, as indicated in Section A8.



Photo One

Photo One Caption REAR VIEW

Photo Two

Photo Two

Photo Two Caption

